



Panel Interface Connectors

Port Adapters



Single Port Shell | M25 Threads | Metal version | UL Type 4, 12 | IP69 Rating

Our smallest Panel Interface Connectors are ideal for tight spaces. The anodized aluminum housing has a connector potted inside and can easily be mounted to a cabinet through a 1" diameter hole. A cap is supplied with each unit to make them suitable for wash down.



| Part Number | Description | Front | Back | Part Number | Description | Front | Back |
|----------------|--|-------|------|---------------|--|-------|------|
| D-USB-AFAF-M25 | USB Female TYPE A to USB Female TYPE A | | | RJ45-M25 | RJ45 Jack to RJ45 Jack | | |
| D-USB-AFBF-M25 | USB Female TYPE A to USB Female TYPE B | | | RJ11-M25 | RJ11 Jack to RJ11 Jack | | |
| D-USB-BFAF-M25 | USB Female TYPE B to USB Female TYPE A | | | RJ22-M25 | RJ22 Jack to RJ22 Jack | | |
| D-USB-BFBF-M25 | USB Female TYPE B to USB Female TYPE B | | | DM6-M25 | 6 PIN Female MINI-DIN to 6 PIN Female MINI-DIN | | |
| BNC-M25 | BNC Jack to BNC Jack | | | DM8-M25 | 8 PIN Female MINI-DIN to 8 PIN Female MINI-DIN | | |
| D-FOPT-2-M25 | 2 Agilent HFBR Fiber Optic Adaptors | | | Cutout | | | |

Standard shell is anodized aluminum, for stainless steel shell add a "-SS" suffix. For low profile nickel plated brass shell, add a "-LP" suffix.

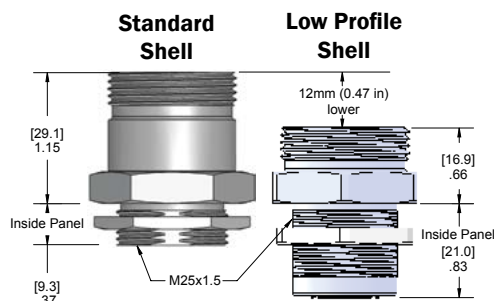

Tightening Torque: 6.7 N-m
Max. Panel Thickness: 4 mm

Tightening Torque: 6.7 N-m
Max. Panel Thickness: 10 mm

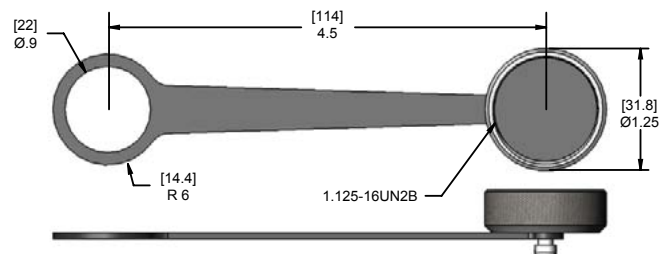

Sealing cap with tether supplied with each unit.
NBR tether also acts as gasket for sealing to panel.