

**The Timken Company**

4500 Mt Pleasant St. NW

N. Canton, OH 44720

**Phone:** (234) 262-3000

**E-Mail:** [CustomerCAD@timken.com](mailto:CustomerCAD@timken.com) • **Web site:** [www.timken.com](http://www.timken.com)

## Part Number 6379, Tapered Roller Bearings - Single Cones - Imperial

This is the most basic and most widely used type of tapered roller bearing. It consists of two main separable parts: the cone (inner ring) assembly and the cup (outer ring). It is typically mounted in opposing pairs on a shaft.

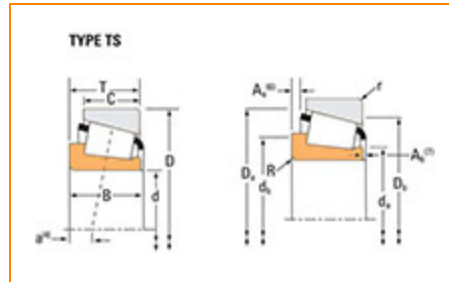

[Specifications](#) | [Dimensions](#) | [Abutment and Fillet Dimensions](#) | [Basic Load Ratings](#) | [Factors](#)

### Specifications

<b>Series</b>	6300
<b>Cone Part Number</b>	6379
<b>Design Units</b>	Imperial
<b>Cage Type</b>	Stamped Steel
<b>C1 - Dynamic Radial Rating (Two-Row, 1 million revolutions)<sup>1</sup></b>	149000 lbf 663000 N
<b>C90(2) - Dynamic Radial Rating (Two-Row, 90 million revolutions)<sup>2</sup></b>	38700 lbf 172000 N



Dimensions

<b>d - Cone Bore</b>	2.5625 in 65.088 mm
----------------------	------------------------

<b>B - Cone Width</b>	2.2050 in 56.007 mm
-----------------------	------------------------

## Abutment and Fillet Dimensions

<b>R - Cone Backface "To Clear" Radius<sup>3</sup></b>	0.14 in 3.600 mm
--	---------------------

<b>da - Cone Frontface Backing Diameter</b>	3.04 in 77 mm
---	------------------

<b>db - Cone Backface Backing Diameter</b>	3.31 in 84 mm
--	------------------

<b>Ab - Cage-Cone Frontface Clearance</b>	0.05 in 1.3 mm
---	-------------------

<b>Aa - Cage-Cone Backface Clearance</b>	0.13 in 3.3 mm
--	-------------------

<b>a - Effective Center Location<sup>4</sup></b>	-0.76 in -19.3 mm
--	----------------------

## Basic Load Ratings

<b>C90 - Dynamic Radial Rating (90 million revolutions)<sup>5</sup></b>	22200 lbf 98800 N
---	----------------------

<b>C1 - Dynamic Radial Rating (1 million revolutions)<sup>6</sup></b>	85600 lbf 381000 N
---	-----------------------

<b>C0 - Static Radial Rating</b>	90900 lbf 404000 N
----------------------------------	-----------------------

<b>C<sub>a90</sub> - Dynamic Thrust Rating (90 million revolutions)<sup>7</sup></b>	12300 lbf 54900 N
---	----------------------

## Factors

<b>K - Factor<sup>8</sup></b>	1.8
<b>G1 - Heat Generation Factor (Roller-Raceway)</b>	124
<b>G2 - Heat Generation Factor (Rib-Roller End)</b>	22.4
<b>Cg - Geometry Factor<sup>9</sup></b>	0.0827

<sup>1</sup> Based on  $1 \times 10^6$  revolutions  $L_{10}$  life, for the ISO life calculation method.

<sup>2</sup> Based on  $90 \times 10^6$  revolutions  $L_{10}$  life, for The Timken Company life calculation method.  $C_{90}$  and  $C_{a90}$  are radial and thrust values for a single-row,  $C_{90(2)}$  is the two-row radial value.

<sup>3</sup> These maximum fillet radii will be cleared by the bearing corners.

<sup>4</sup> Negative value indicates effective center inside cone backface.

<sup>5</sup> Based on  $90 \times 10^6$  revolutions  $L_{10}$  life, for The Timken Company life calculation method.  $C_{90}$  and  $C_{a90}$  are radial and thrust values.

<sup>6</sup> Based on  $1 \times 10^6$  revolutions  $L_{10}$  life, for the ISO life calculation method.

<sup>7</sup> Based on  $90 \times 10^6$  revolutions  $L_{10}$  life, for The Timken Company life calculation method.  $C_{90}$  and  $C_{a90}$  are radial and thrust values for a single-row,  $C_{90(2)}$  is the two-row radial value.

<sup>8</sup> These factors apply for both inch and metric calculations. Consult your Timken representative for instruction on use.

<sup>9</sup> Geometry constant for Lubrication Life Adjustment Factor  $a_3$ .

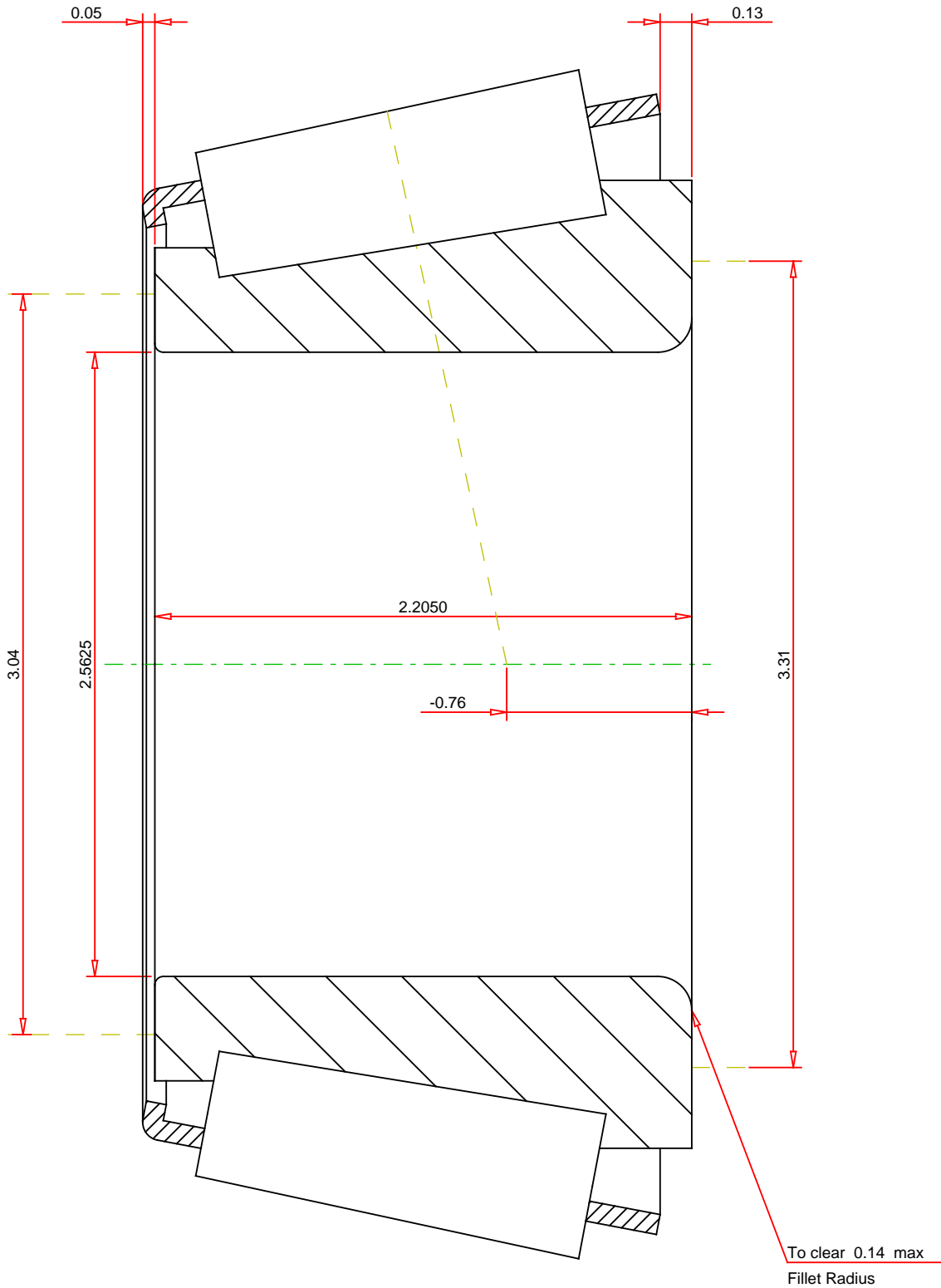

IMPERIAL UNITS

<div>Number of Rollers Per Row15</div>	<div><div>TIMKEN®</div><div>THE TIMKEN COMPANY</div><div>NORTH CANTON, OHIO USA</div></div>	<div><div>6379</div><div>Tapered Roller Bearings - Single Cones - Imperial</div></div> <div><div><div>K Factor</div><div>Dynamic Radial Rating - C90</div><div>Dynamic Thrust Rating - Ca90</div><div>Dynamic Radial Rating - C1</div></div><div><div>1.8</div><div>98800 lbf</div><div>54900 lbf</div><div>381000 lbf</div></div></div>
<div>Every reasonable effort has been made to ensure the accuracy of the information contained in this writing, but no liability is accepted for errors, omissions or for any other reason.</div>		<div>FOR DISCUSSION ONLY</div>