

**Ball valve**  
**VZBE-3/4-T-63-F-3L-F04-M-V15V15**  
 Part number: 8096946

**FESTO**

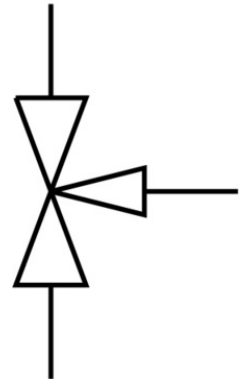
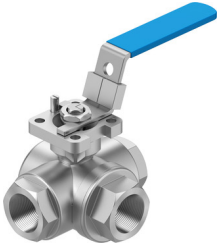

**Data sheet**

Feature	Value
Type code	VZBE
Seat seal material	PTFE
Design	3-way ball valve Drilled L hole
Actuation type	Mechanical
Sealing principle	Soft
Mounting position	Any
Type of mounting	Line installation
Fitting connection	3/4 NPT
Switching position indication	Slot direction = flow direction
Flange hole pattern	F04
Inside diameter	16 mm
Nominal width DN	20
Valve function	3/2
Flow direction	Reversible
Nominal pressure of fitting PN	63
Breakaway torque at differential pressure, nominal pressure, fitting PN	14.3 Nm
Based on norm	ASME B1.20.1 ISO 5211
Symbol	00991888
Medium	Vapor Compressed air as per ISO 8573-1:2010 [:-:-] Inert gas Water Neutral liquids
Temperature of medium	-20 °C ... 200 °C
Flow rate Kv type L	3.2 m³/h
Note on materials	Contains paint-wetting impairment substances RoHS-compliant
Housing material	Cast stainless steel
Material number of housing	1.4408

Feature	Value
Seals material	PTFE
Ball material	Cast stainless steel
Material number for ball	1.4408
Shaft material	High-alloy stainless steel
Material number for shaft	1.4401
Product weight	1100 g
Certification	CRN
Corrosion resistance class (CRC)	4 - Particularly high corrosion stress
Explosion prevention and protection	Zone 1 (ATEX) Zone 2 (ATEX) Zone 21 (ATEX) Zone 22 (ATEX)