

Connection block MHP1-P2-2-PI

Part number: 197217

FESTO

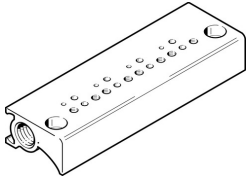

Data sheet

| Feature | Value |
|--|--|
| Type code | MHP1-P2 |
| Max. no. of valve positions | 2 |
| Operating pressure | 0 bar ... 8 bar |
| Operating medium | Compressed air as per ISO 8573-1:2010 [7:4:4] |
| Information on operating and pilot media | Operation with oil lubrication possible (required for further use) |
| Corrosion resistance class (CRC) | 1 - Low corrosion stress |
| Ambient temperature | -10 °C ... 60 °C |
| Sub-base mounting type | With through-hole |
| Pneumatic valve mounting type | With internal thread |
| Pneumatic connection 1 | M7 |
| Material of sub-base | Wrought aluminum alloy |