

# Swing clamp cylinder CLR-20-20-L-P-A

Part number: 535442

**FESTO**

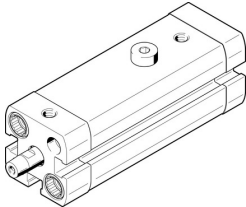

## Data sheet

| Feature                                      | Value  |
|--|--|
| Complete stroke                              | 32 mm  |
| Piston diameter                              | 20 mm  |
| Piston rod thread                            | M6   |
| Swivel angle                                 | 90 deg +/- 3 deg   |
| Clamping stroke                              | 20 mm  |
| Type code                                    | CLR  |
| Cushioning                                   | Elastic cushioning rings/pads at both ends                                   |
| Mounting position                            | Any  |
| Design                                       | Piston<br>Piston rod<br>Cylinder barrel                                      |
| Position sensing                             | For proximity sensor   |
| Swivel direction                             | Left   |
| Symbol                                       | 00991217   |
| Operating pressure                           | 2 bar ... 10 bar   |
| Mode of operation                            | Double-acting  |
| Operating medium                             | Compressed air as per ISO 8573-1:2010 [7:4:4]                                |
| Information on operating and pilot media     | Operation with oil lubrication possible (required for further use)           |
| Corrosion resistance class (CRC)             | 2 - Moderate corrosion stress  |
| Ambient temperature                          | -10 °C ... 80 °C   |
| Effective clamping force at 2 bar            | 35 N   |
| Effective clamping force at 4 bar            | 73 N   |
| Effective clamping force at 6 bar            | 109 N  |
| Max. clamping finger screw tightening torque | 12 Nm  |
| Theoretical clamping force at 6 bar          | 121 N  |
| Product weight                               | 385 g  |
| Type of mounting                             | Optionally:<br>With through-hole<br>With internal thread<br>With accessories |
| Pneumatic connection                         | M5   |
| Flange screws material                       | Steel<br>Galvanized  |
| Cover material                               | Wrought aluminum alloy<br>Coated   |
| Seals material                               | NBR<br>TPE-U(PU)   |

| Feature                     | Value                                     |
|-----------------------------|---|
| Housing material            | Wrought aluminum alloy<br>Smooth anodized |
| Piston rod material         | High-alloy stainless steel                |
| Material of cylinder barrel | Wrought aluminum alloy<br>Smooth anodized |