

MALE END VIEW

(LONG)

3

4

2

5

1

SPECIFICATIONS	
CONTACT CARRIER MATERIAL	TPU
CONTACT MATERIAL/PLATING	BRASS/GOLD
HOUSING MATERIAL/PLATING	BRASS/NICKEL
O-RING MATERIAL	NITRILE
RATED CURRENT [A]	9.0 A
RATED VOLTAGE [V]	600 V
SOLDER CUP [MAX]	UP TO 16 AWG
TEMPERATURE RATING	-30°C to +80°C (-22°F to +176°F)
PROTECTION CLASS	MEETS NEMA 1,3,4,6P AND IEC IP67

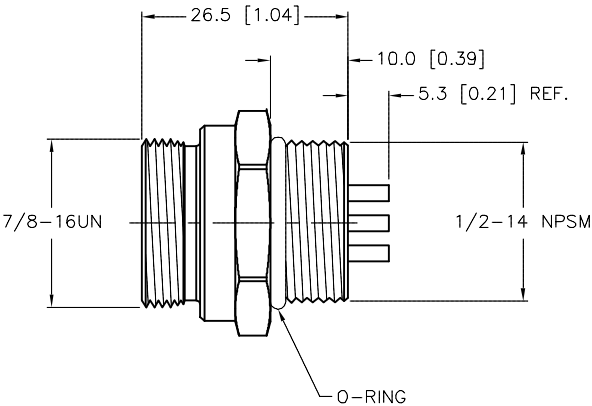
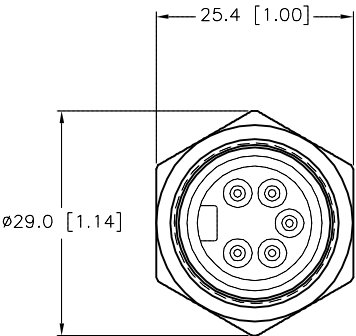

SOURCE DRAWING - FOR REFERENCE ONLY

<div>RELATED DOCUMENTS</div> <div>1. 2. 3. 4.</div>					<div>3RD ANGLE PROJECTION</div> <div></div>		<div>THIS DRAWING IS CONFIDENTIAL AND THE PROPERTY OF TURCK INC. USE OF THIS DOCUMENT WITHOUT WRITTEN PERMISSION IS PROHIBITED.</div>		<div></div> <div>3000 CAMPUS DRIVE MINNEAPOLIS, MN 55441 1-800-544-7769 (763) 553-7300 (763) 553-0708 fax www.turck.us</div>			
					MATERIAL		DRFT		DATE		DESCRIPTION	
					SEE SPECIFICATIONS		JB		02/27/04			
FINISH		ALL DIMENSIONS DISPLAYED ON THIS DRAWING ARE FOR REFERENCE ONLY		APVD		SCALE		IDENTIFICATION NO.		REV		
SEE SPECIFICATIONS						1=1.0						
		CONTACT TURCK FOR MORE INFORMATION		UNIT OF MEASUREMENT		DO NOT SCALE THIS DRAWING		FILE: U5229-12		SHEET 1 OF 1		
				MILLIMETER [INCH]								

B	ADD O-RING PER ECO	KMY	12/06/12	40601
REV	DESCRIPTION	BY	DATE	ECO NO.