



MDC (M12) Series Receptacles

4 & 5 Conductor MDC Series Receptacles



PCB Mount Male Receptacles | 250 Volt, 4 amps | IP69/IP67 Rating

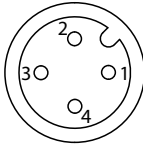
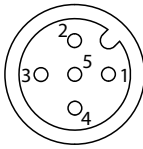

# of Poles	Male Faceview	Rating	Style	Straight	Right Angle
4	 M12 x 1	250V 4A	PCB Mount IP69	MDC-4MR-PCB	MDC-4MR-PCB-R
			PCB Mount w/ Ground Tab IP67	MDCM-4MR-PCB	MDCM-4MR-PCB-R
5	 M12 x 1	250V 4A	PCB Mount IP69	MDC-5MR-PCB	MDC-5MR-PCB-R
			PCB Mount w/ Ground Tab IP67	MDCM-5MR-PCB	MDCM-5MR-PCB-R

Male Straight

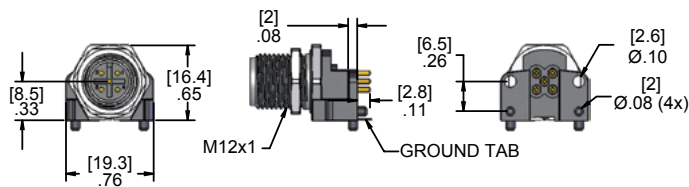

Male Right Angle

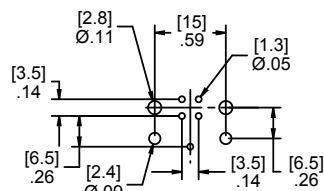
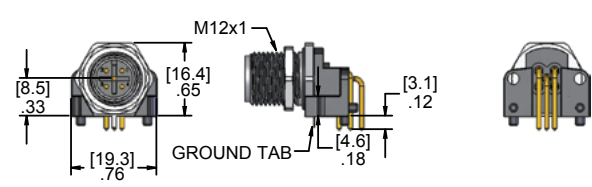

4 Pole Female Straight Layout

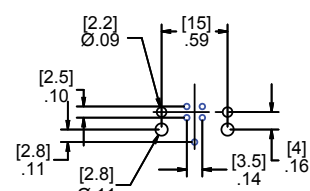
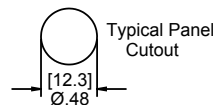

4 Pole Female Right Angle Layout

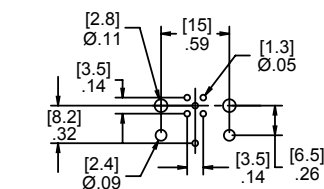
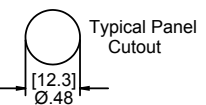

5 Pole Female Straight Layout

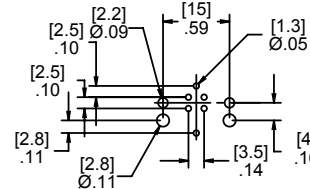

5 Pole Female Right Angle Layout

Specifications:

Body: Polyamide
Contacts: Copper Alloy with Gold Plating
Shell: Nickel Plated Brass

O-Ring: NBR
Jam Nut: Nickel Plated Brass
Temperature: -40°C to 105°C (-40°F to +221°F)